

# Beverly – Sub 92 (Muscatine County) Transmission Line Project

## PROJECT OVERVIEW

ITC Midwest is planning to build an electric transmission line that travels through Linn, Johnson and Muscatine counties from ITC Midwest's Beverly Substation in Cedar Rapids (Linn County) to the Sub 92 Substation owned by MidAmerican Energy, which is located near West Liberty in Muscatine County. The proposed route in Muscatine County includes constructing a new 345,000 volt (345 kV) transmission line that will be routed out of the Sub 92 Substation near West Liberty. It will be double circuited (two circuits on the same structures) for a short distance with an existing 345 kV line. The existing line will be removed and rebuilt to allow for the double circuit configuration. The new 345 kV line will then join the route of an existing 161 kV transmission line which will be removed and rebuilt. In other words, the existing 161 kV line will be removed and co-located on the same structures as the new 345 kV line. The line will be routed westward into Johnson County. Altogether through the three counties the line is approximately 49 miles. The segment in Muscatine County is approximately 7.9 miles. The final route may change and will be determined when easement negotiations with landowners are completed and the Iowa Utilities Commission has approved the project. (Please see map of the proposed line route corridor in Muscatine County on the back.)

### ***Why is this line needed?***

Responding to the needs of the changing energy landscape, the Midcontinent Independent System Operator – MISO – the grid planning organization for our region, has devoted several years of intensive, collaborative effort to develop a Long-Range Transmission Plan – known as LRTP – to build needed high-voltage transmission infrastructure across the region. ITC Midwest was actively involved with this process and advocated for the LRTP projects. One segment of the LRTP portfolio is the proposed Beverly – Sub 92 project.

**The Beverly – Sub 92 project will provide numerous benefits and drive value for electric consumers locally and regionally. When completed, this transmission line will:**

- Increase transmission infrastructure to **improve system reliability**
- Enhance grid resilience to better **withstand extreme weather**
- **Expand access to generation resources** for electric consumers by reducing transmission system congestion
- Improve distribution of **lower-cost energy resources**, including renewables

### ***Whose approval is required to build this line?***

The Iowa Utilities Commission (IUC) grants regulatory approvals, called franchises, to Iowa utilities seeking to build transmission lines in the state. As part of its review process, the IUC reviews many aspects of the project such as the need for the line and the proposed route. The IUC has very clear criteria and a clear process for utilities to follow to request a franchise.

### ***What is being done to ensure this line will be safe?***

This line will be designed to meet and even exceed the National Electrical Safety Code (NESC), the nationally-recognized design standard in the United States, as well as the Iowa Electrical Safety Code. Among other things, these codes require construction to meet clearance requirements and withstand extreme weather conditions. As the line owner, ITC Midwest will make sure that the line is clear of trees and other vegetation.



**FOR THE GREATER GRID.**

**ITC MIDWEST** 3165 Edgewood Parkway SW, Cedar Rapids, IA 52404  
Locations: Albert Lea, Des Moines, Dubuque, Iowa City, Lakefield, Perry  
**877.ITC.ITC9** (877.482.4829) | [www.itcmidwest.com](http://www.itcmidwest.com)

# Beverly – Sub 92 (Muscatine County) Transmission Line Project

## What is ITC Midwest doing to minimize impact on landowners and current land uses?

ITC Midwest seeks to minimize the impact of the line on existing land uses. The company is committed to protecting the environment and will fully compensate landowners for any damages that occur during the construction process.

Where possible, this line will be co-located on the same structures with existing transmission lines to mitigate the need for a new transmission corridor across privately owned land. To minimize the footprint of the line, ITC Midwest plans to use steel monopoles.

## How will ITC Midwest work with landowners?

Under Iowa law, ITC Midwest cannot negotiate for easements until after the Iowa Utilities Commission holds a public information meeting. For this project, the Muscatine County meeting was held in West Liberty on October 30, 2024. In the coming weeks, ITC Midwest representatives will begin meeting with affected landowners in the proposed corridor to explain the process and their rights, and ultimately, to begin negotiations to secure voluntary easements.

Landowners are compensated for permitting ITC Midwest to secure an easement on their property. ITC Midwest understands and appreciates the impact that line construction has on landowners and pledges to treat *all* landowners with the utmost respect during this important process.

## Beverly – Sub 92 project proposed line corridor route in Muscatine County

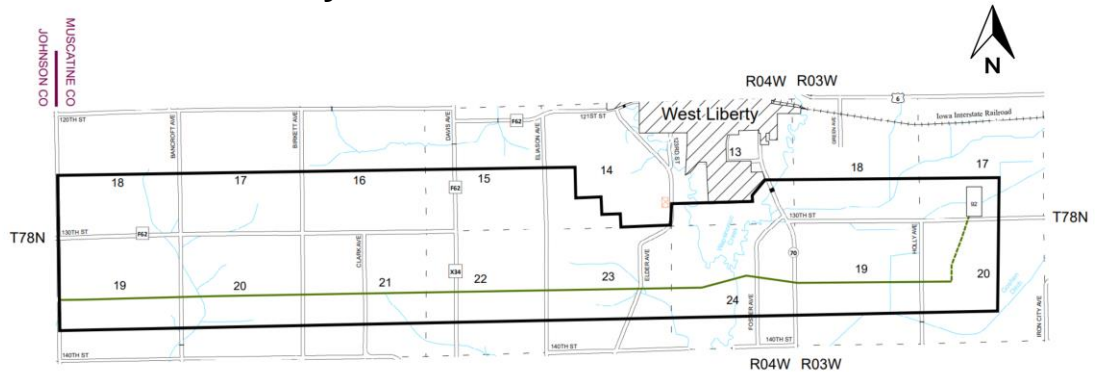

LEGEND	
	Proposed Double Circuit 345kV ITC/161kV MEC Transmission Line
	Proposed Double Circuit 345kV ITC/345kV MEC Transmission Line
	Notification Corridor
	Sub 92 Substation - MidAmerican Energy Company
	Mount Calvary Cemetery
	Corporate Limits
	Railroad
	Section Line
	Hydrology
	Bridges
	Roads
	County Highway
	State Highway
	US Highway

	<b>Beverly - Sub 92</b> Proposed 345kV Electric Transmission Line Muscatine County, IA	Not to Scale Date: 9/4/2024 Drawing No: Notification Corridor Page: 1 of 1
--	--	---

## Project Contacts

If you have questions, you can contact ITC Midwest using our toll-free customer line at 1-877-482-4829. Once construction begins, Shawn Mathis and Cory Turenne will be ITC Midwest’s project leads.



**Shawn Mathis**  
Project Manager  
(319) 899-2163  
[smathis@itctransco.com](mailto:smathis@itctransco.com)



**Cory Turenne**  
Field Supervisor  
(262) 689-3033  
[cturenne@itctransco.com](mailto:cturenne@itctransco.com)